

# Tools

Pruning shears	63
Pole saws	64 - 65
Hand saws	66 - 67
Transport trolley	68 - 69



FELCO only uses high-resistance and lightweight materials. The high quality steel and perfect heat treatment used in their manufacture guarantees that FELCO shears are extremely durable, with cutting heads that give impressive cutting performance and have a long lifespan. In order to guarantee the durability of their tools, FELCO ensure the availability of spare parts.

## Felco 2

The classic model, with light robust handles and non-skid buffer shock-absorbers. The blade is made of high quality hardened steel and guarantees a clean and precise cut. Wire cutter integrated. All parts replaceable.

**CF 2**                      35,00 €                      41,65 €



## Case for Felco tree shears

Real leather case with strap and fastener for wearing on your belt.

**CF 91**      15,00 €      17,85 €



## Felco 5

The standard model, with robust steel handles. The blade and the counter blade, which are made of hardened steel, guarantee a clean and precise cut. All parts are replaceable.

**CF 5**                      19,00 €                      22,61 €



Tools

Product	Name	Length (mm)	Opening (mm)	Weight (g)	Price
CF 2	Felco 2	215	69	240	35,00 €
CF 5	Felco 5	225	54	310	19,00 €
CF 7	Felco 7	210	60	290	49,00 €
CF 8	Felco 8	210	60	245	35,00 €

## Felco 7

The professional model, with light robust handles and non-skid buffer shock-absorbers. The blade is made of hardened steel and guarantees a particularly clean cut. Wire cutter included. All parts replaceable. The wrist is protected and guarded by the roll handle and the angled cutting head.

**CF 7**                      49,00 €                      58,31 €



## Felco 8

The professional model, with light robust handles and non-skid buffer shock-absorbers. The blade is made of high quality steel and guarantees a clean precise cut. Wire cutter included. All parts replaceable. The ideal handle shape protects the wrist and minimises effort.

**CF 8**                      35,00 €                      41,65 €



## Telescopic cutter ARS 180 ZT

The adjustable-length saw for cutting and pruning young trees.

Weight: 1350 g.

**CFT 10**                      102,90 €                      122,45 €





## Pole saw Ergoschnitt



The light FPA tested, inductively hardened blade with is specially sharpened and guaranties efficient and easy cutting. The continuously adjustable pole made of non-conductive glass fibre is 5 time as resistant as aluminium.

1,4 m - 2,8 m	<b>CST 31</b>	155,00 €	184,45 €
2,3 - 5,4 m	<b>CST 30</b>	179,00 €	213,01 €
Replacement blade	<b>CSTE 30</b>	50,00 €	59,50 €
Pole for CST 30	<b>CST 303</b>	129,25 €	153,81 €

## Spare parts Ergoschnitt



Hook	<b>CST 301</b>	21,90 €	26,06 €
Textil scabbard	<b>CST 302</b>	12,00 €	14,28 €

Name	Reference	Length with blade (mm)	Elements	Blade length (mm)	Tooth pre inch	Weight (g)
ARS EXP-4.5 UV 47	CST 11	2380 - 5200	3	470	6	2220
Ergoschnitt ERS 233	CST 31	1450 - 2830	3	390	6,7	1760
Ergoschnitt ERS 490	CST 30	2300 - 5400	3	390	6,7	2720
Silky Hayauchi	CST 21	2280 - 3670	2	390	5,7	1850
Silky Hayauchi	CST 20	2350 - 4900	3	390	5,7	2750
Silky Longboy	CST 24	1450 - 3600	2	360	6,6	1950



## Pruner adaptor for ARS saws



Continuous adjustable pruners adaptor with small mechanical advantage for branches up to 40mm.

For CST 11	<b>CSTA 10</b>	119,00 €	141,61 €
------------	----------------	----------	----------



## Pole saws ARS



The 3 times sharpened teeth (4,5mm) are made of nickel-plated carbon steel allow you efficient pruning. The head includes a hook and straight knife and is rapidly detachable. Length during transport: 1,8m. Includes textile scabbard.

2,4 - 5,2 m	<b>CST 11</b>	190,00 €	226,10 €
Replacement blade	<b>CSTE 11</b>	59,00 €	70,21 €
Scabbard for CST 11	<b>CSTE 111</b>	19,50 €	23,20 €



## Pole saw Hayauchi

The excellent cutting performance thanks to the cambered, hard-chrome plated blade is appreciated amongst professional arborists, landscapers and forestry workers. The blade can be inclined and provides a stopper nose to avoid losing the cut. The oval pole with a large rubber handle includes a plastic scabbard.

2,3 - 3,7m	<b>CST 21</b>	199,00 €	236,81 €
2,3 - 4,9m	<b>CST 20</b>	209,00 €	248,71 €
Replacement blade	<b>CSTE 20</b>	64,90 €	77,23 €
Pole	<b>CSTE 203</b>	117,65 €	140,00 €



Tools

### Hook for pole saw

Hook for CST 20/21 **CST 201** 25,00 € 29,75 €

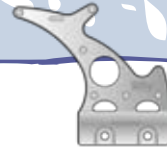

### Scabbard for pole saw

Scabbard for CST 20/21 **CSTE 22** 15,00 € 17,85 €



## Pole saw „Longboy“

Lightweight, state-of-the-art telescoping folding pole saw - The pole saw of choice by professionals. The aluminium alloy extension poles are oval shaped, providing precise control over the direction of the blade (especially important for high cutting) thus reducing bending to the minimum. The base pole has a pole-end shock absorber and comfortable rubberized overgrip. This aluminium pole saw comes equipped with an innovative blade cover that securely locks to the lower pole when blade is folded.

1,4 - 3,6m	<b>CST 24</b>	230,00 €	273,70 €
Replacement blade	<b>CSTE 24</b>	57,90 €	68,90 €



## Folding saw

The curved handle fits comfortably in the hand. The ARS folding saw features a rubber coating for continued heavy sawing and a Marquench hardened, precision ground, high carbon tool steel blade for improved sharpness and durability. The blade is hard chrome plated for rust and sap resistance. Manufacturer: ARS. Only 175g.

Folding saw	<b>C 15</b>	29,00 €	34,51 €
Replacement blade	<b>CE 15</b>	19,00 €	22,61 €



## Throw saw

The throw saw consists of a two directional saw chain to be controlled with the help of a 50m dyneema throw line. This allows you to fell safely hanging over thrown trees. The throw line enables you to place the saw chain precisely. Just attach slings to the non-conductive throw line and start to saw.

25 m	<b>WUS 100</b>	239,00 €	284,41 €
------	----------------	----------	----------





## Natanoko

Very good cutting performance thanks to the 33cm long straight saw blade.

Supplied with a plastic scabbard

Natanoko	<b>C 21</b>	56,90 €	67,71 €
Replacement blade	<b>CE 21</b>	39,00 €	46,41 €



## Gomtaro

Universal saw with straight saw blade. Blade length: 33cm. Also available with a fine teeth. Supplied with a plastic scabbard.

Gomtaro	<b>C 23</b>	49,00 €	58,31 €
Replacement blade	<b>CE 23</b>	29,90 €	35,58 €
Gomtaro, fine	<b>C 231</b>	49,00 €	58,31 €
Replacement blade, fine	<b>CE 231</b>	29,90 €	35,58 €

### Toothing

Big: 8 tooth per 30 mm

Fine: 13 tooth per 30 mm

## Gomtaro, Sentei

Special blade with different toothing. Best for orchard and young tree pruning. 240mm blade length. With plastic scabbard.

Sentei	<b>C 26</b>	55,90 €	66,52 €
Replacement blade	<b>CE 26</b>	33,90 €	40,34 €

## Gomtaro, Root cut

Special saw blade which remains sharp for a long time when in contact with the soil. Blade length: 24cm. Supplied with a plastic scabbard.

Gomtaro root cut	<b>C 25</b>	46,90 €	55,81 €
Replacement blade	<b>CE 25</b>	29,90 €	35,58 €



### SawPod

This saw holder allows the handsaw to be carried on the lower leg.

SawPod	<b>CKF 100</b>	30,00 €	35,70 €
Francital	<b>CKF 200</b>	12,50 €	14,88 €



## Sugoi

Sugoi means "incredible" and that's exactly the word for this rapid cutting and aggressive saw (5.5 teeth per inch). Ideal for pruning large limbs, with a knife blade on the hooked tip for slicing away vines and clinging plants. Blade length: 36cm.

Sugoi	<b>C 27</b>	79,90 €	95,08 €
Replacement blade	<b>CE 27</b>	54,90 €	65,33 €



## Zubat

Curved handsaw with a 33cm blade, rubber handle and plastic scabbard. Very good cutting performance.

Zubat	<b>C 22</b>	59,00 €	70,21 €
Replacement blade	<b>CE 22</b>	39,00 €	46,41 €



## Ibuki

Large curved handsaw with 39cm blade, rubber handle and plastic scabbard. Superb cutting performance.

Ibuki	<b>C 24</b>	79,90 €	95,08 €
Replacement blade	<b>CE 24</b>	54,90 €	65,33 €



### TurboCut

Curved handsaw with wooden handle. The 1.1mm thick blade gives a particularly high cutting performance. Impulse-hardened 32cm blade.

Hand saw	<b>C 11</b>	31,90 €	37,96 €
Replacement blade : 1,1 mm	<b>CE 11</b>	25,90 €	30,35 €
Replacement blade : 1,3 mm	<b>CE 111</b>	25,90 €	30,35 €



### PS 32

Felling saw with straight 33cm blade and wooden handle.

Hand saw	<b>C 12</b>	43,90 €	52,24 €
Replacement blade	<b>CE 12</b>	34,90 €	41,53 €



### PS 30

Handsaw with straight 30cm blade and wooden handle. Ideal for working on thin branches.

Hand saw	<b>C 14</b>	38,30 €	45,81 €
Replacement blade	<b>CE 14</b>	29,90 €	35,76 €



### Hand saw Ergo 270

The slightly curved saw blade made from time-proven SK4 Japanese steel has a hard chrome coating and the rows of teeth are induction hardened. 270mm curved blade, 8 teeth per 30mm, weight: 281g. KWF approved.

Hand saw	<b>C 320</b>	39,92 €	47,50 €
Replacement blade	<b>CE 320</b>	29,90 €	35,58 €

### Leather scabbard

Hand stitched in genuine leather scabbard. Without tools. Suits all Handsaws and pruners but IBUKI.

Straight, right	<b>CKL 20</b>	54,90 €	65,33 €
Straight, left	<b>CKL 201</b>	54,90 €	65,33 €

Suits all Handsaws and pruners but IBUKI. (C 24)

Curved, right	<b>CKL 10</b>	54,90 €	65,33 €
Curved, left	<b>CKL 101</b>	54,90 €	65,33 €

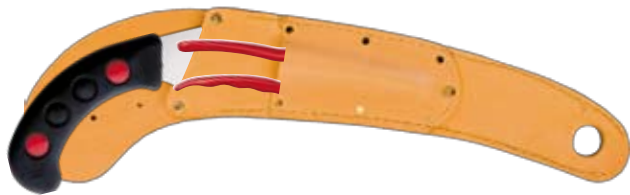

### Leather scabbard

Hand stitched in genuine leather with pruners pocket. Without tools. Suits all Handsaws and pruner but IBUKI.

Curved, right	<b>CKL 40</b>	54,90 €	65,33 €
---------------	---------------	---------	---------



### ARS Cam 24 Pro

Handsaw with ergonomic handle and straight 24cm blade. Supplied with a plastic scabbard.

Hand saw	<b>CAM 024</b>	42,90 €	51,05 €
Replacement blade	<b>CAME 024</b>	27,50 €	32,73 €



### ARS CT 32 Pro

Handsaw with ergonomic handle and straight 24cm blade. Supplied with a plastic scabbard.

Hand saw	<b>CT 032</b>	59,00 €	70,21 €
Replacement blade	<b>CTE 032</b>	39,00 €	46,41 €

# Lifting and transporting trolley

The 2.5m-long lever arm of the GS-tested transporting trolley multiplies your muscle power significantly. The use of machinery can be reduced without compromising on the health of the user. A range of tasks can be managed alone. The axis, which is only 68cm wide, and the soil friendly tyres mean that it can be used on both rough terrain and cultivated areas.

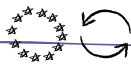

## Base frame

The adjustable base frame multiplies performance and capacity and has a maximum axle load of 500kg. Attachment device not supplied.

**HT 100** 399,00 € 474,81 €

## Base frame

Base frame with extra strong tyre pattern.

**HT 101** 448,00 € 533,12 €



## Stacking function

Multifunctional stacking function for stack able objects.

**HT 110** 159,00 € 189,21 €



## Universal trolley

To be used as a standard load trolley.

**HT 120** 164,00 € 195,16 €

## Technical data

Steel rim with precision bearing  
Rubber tyre 400 x 100 mm

Width	690 mm
Weight	30 - 33 kg
Height	1500 - 2500 mm
Charge axis	500 kg
Carrying load	250 - 460 kg

## Boulder/bale device

Multifunctional device for use in landscape and garden design.

**HT 140** 199,00 € 236,81 €



## Bucket platform

The bucket platform allows a comfortable transport of all pots and buckets. Similar to a forklift the platform is inclinable to securely transport palettes and pots. A additional side rail is can be installed without the use of use of tools.

**1** Platform **HT 180** 299,00 € 355,81 €  
**2** Side rail **HT 181** 69,00 € 82,11 €

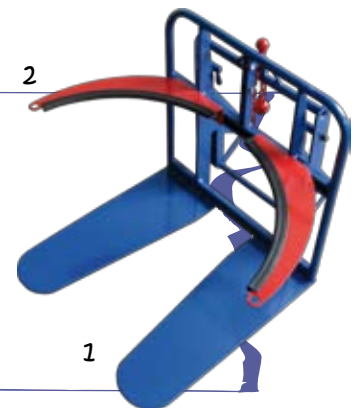

## Tyre equipment

Large tyre pattern with higher carrying load.

**HT 1010** 49,00 € 58,31 €  
**HT 1000** 32,50 € 38,68 €



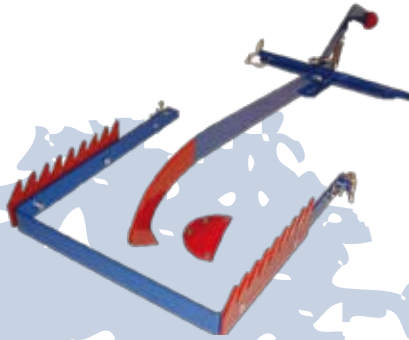

## Wood moving device

For transporting stem wood in a manner that protects the user's back.

**HT 160** 199,00 € 236,81 €



## Log-moving device

This new log-moving device, comprising gripping pliers and trailer truck, enables the effortless movement of logs while protecting the soil structure. It allows one person to move the wood from the felling location to the vehicle.

**HT 170** 596,50 € 709,84 €

Apart from the lifting and carrying technique the size and shape of load is a significant factor to determine the physical effort. A great range of different parameters (ex: age, sex, physical shape and condition, height of lifting, transport distance, transport time, frequency of lifting and carrying) are to respect before determining the maximum load to be moved by a person.



Tools

## Adjustable hook

Creates a lifting or pulling movement to enable transport.

**HT 130** 199,00 € 236,81 €



## Attention!

The adjustable hook (HT 130) is necessary to use the log-moving device.

## Log-moving device with base frame

Base frame (HT 100), adjustable hook (HT 130), trailer (HT 170) to transport logs up to 600kg weight and 80 cm diameter.

**HTSET 100** 1165,00 € 1386,35 €

